

**Ella Glue Up Tile Flange Kit  
for Bathtub and Shower Base**

**Description:**

The glue up tile flange kit presents an innovative solution for bath tubs and shower trays. This incorporates the revolutionary Sealux waterproof membrane and a pink siliconized strip, which are uniquely designed and patented to create a strong bond. This combination ensures exceptional adhesion and flexibility, guaranteeing effective waterproofing even when the gap between the floor and the wall experiences expansion or contraction.

This bundle contains a custom cut size roll of Glue Up Tile Flange strip, a multipurpose spatula, an alignment guide card, two alcohol wipes and a comprehensive installation instruction sheet. Glue Up Tile Flange can be installed on various different types of bathtubs and shower base that include integral tiling flanges.



**Specs:**

- Patented Material Fleece Water Proof Membrane.
- Custom cut to size.
- Installation pink silicone-based strip has tenacious adhesion and flexibility.
- Guarantees waterproofing during the expansion
- Easy to install.
- Designed to conceal and protect the silicone from direct exposure to the deteriorating effects shower environments.

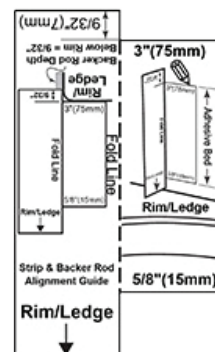
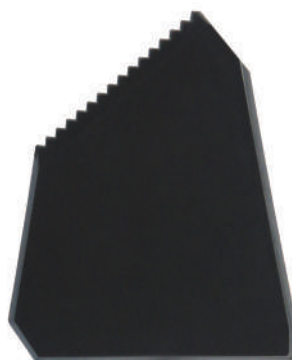

Utility Spatula

Alignment Card

Alcohol Wipes

## Ella Glue Up Tile Flange Kit Installation Instructions

1. Clean the walls make sure they are dust and debris free. You will need to apply Marks and Painters tape to the walls



3. Remove the Tub from area using a level to finish the lines if necessary.



5. Remove light blue stick tape on the back of the strip leaving the strip hanging not bonded to the wall.

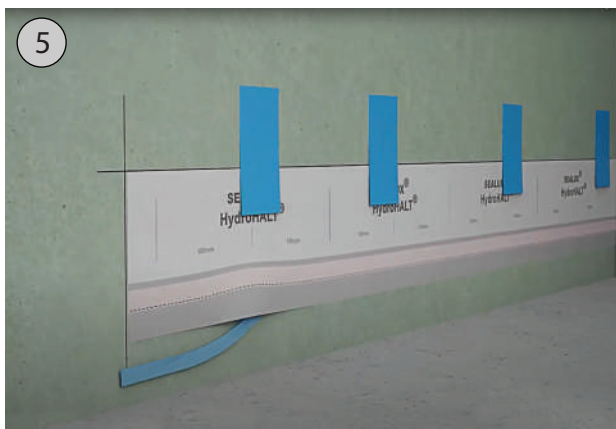

2. Draw wall lines using Alignment Card. These two lines define the adhesive bed upper and lower boundaries



4. Using painters tape to hold the strip to the wall. Apply the pink strip out bottom side down aligned with wall marks.

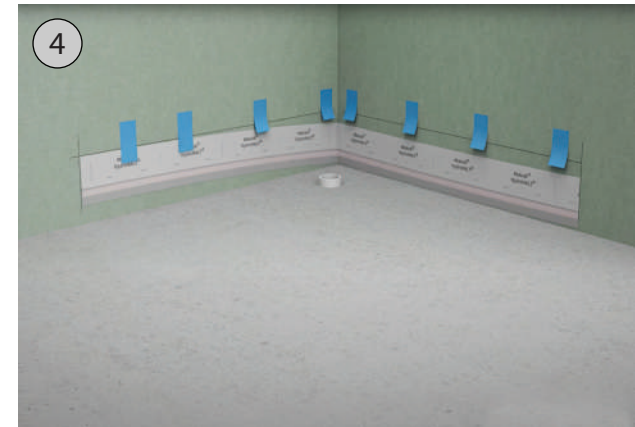

6. Start in corners with smooth side of the utility spatula. Press bond from corners out to edges.

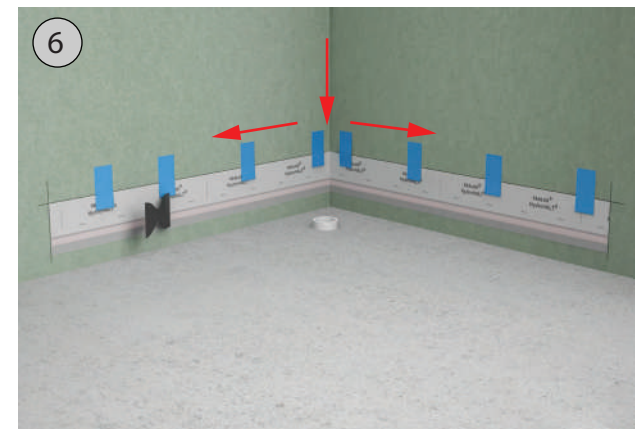



## Ella Glue Up Tile Flange Kit Installation Instructions

7. Apply painters tape on outside of the strip on top and sides. This will allow adhesive sealant not to smear to the wall.



8. Gently fold down the strip and apply adhesive in a wave pattern across the entire wall staying inside the lines.



9. Using the utility spatula with the tiny grooved edge start in corners and work outward to even out the adhesive on all sides of the tub.



10. Fold back the strip evenly then apply the adhesive in a wave pattern.

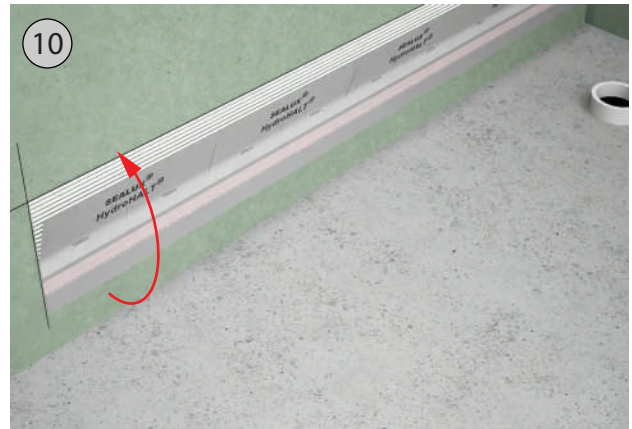

11. Using the utility spatula with the smooth side start in corners and work outward making an even finish.

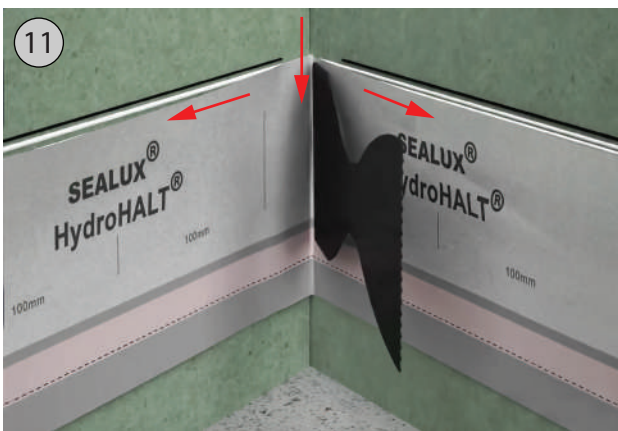

12. Gently remove painters tape off the wall if applied.



## Ella Glue Up Tile Flange Kit Installation Instructions

13. Using the alcohol wipes clean the rim of the tub/shower base. For Alcove install please go to page 4.



15. Apply painters tape on the rim of the tub this allows easy clean up for over spill.



17. Use the small cut side on the spatula to run over the silicone. Start from corners out wipe excess silicone away making a smooth line.

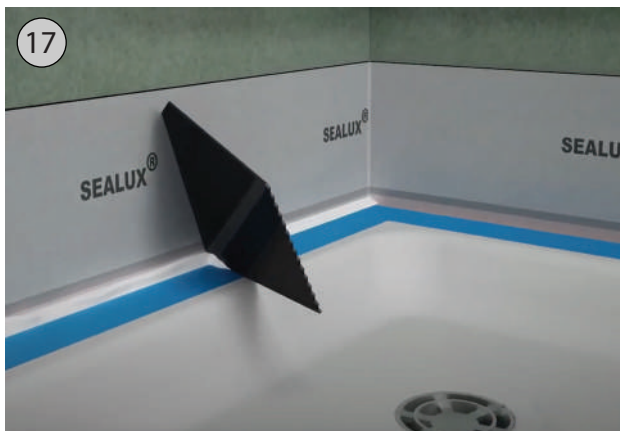

14. Apply the 100% silicone behind the base to make sure it covers completely the patented pink silicone film (adhesive face) for flexible leak proof bond.

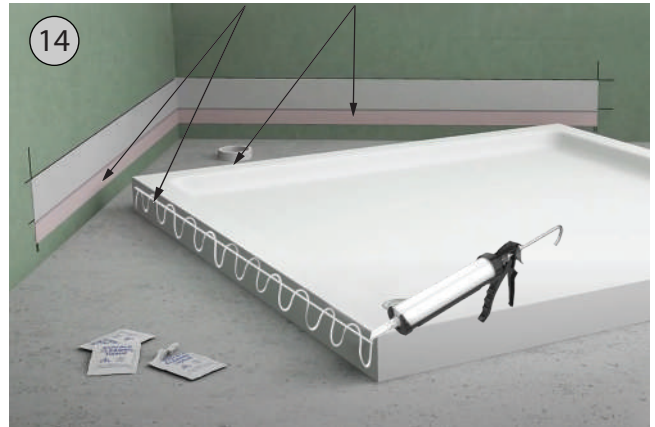

16. Apply silicone along the edge of the rim and strip make sure to fill in the gap behind the tub/shower base.



18. Gently remove the painters tape. The tub/shower base is ready for tile application.







by ella's bubbles

## Ella Glue Up Tile Flange Kit Installation Instructions

19. For alcove installation, silicone goes on the back lip of the tub, not the outer sides.



21. Apply enough silicone to cover the patented pink silicone film behind the tub, extending 1½" down for a leak-proof bond.

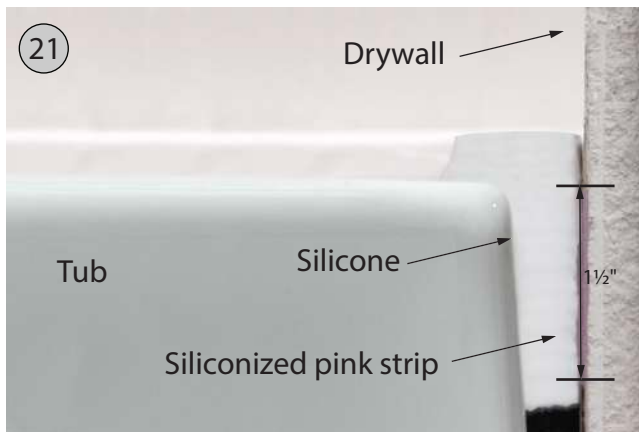

23. Use the small cut side on the spatula to run over the silicone. Start from corners out wipe excess silicone away making a smooth line.

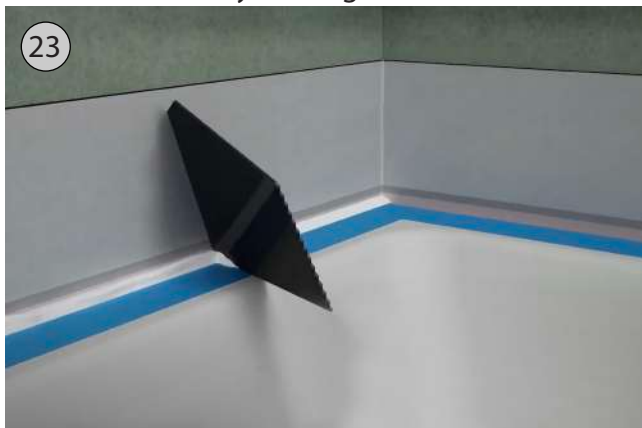

20. Apply painters tape on the rim of the tub this allows easy clean up for over spill.



22. Apply silicone along the edge of the rim and strip make sure to fill in the gap behind the tub.

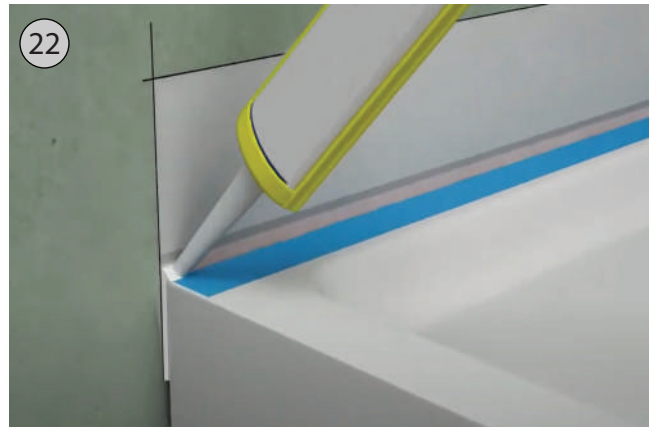

24. Gently remove the painters tape. The tub deck is ready for tile application.





by ella's bubbles

# Ella Glue Up Tile Flange Kit Installation Instructions

25. When 100% silicone is applied to the patented siliconized pink strip of Sealux waterproof membrane. It creates tenacious adhesion and flexibility.

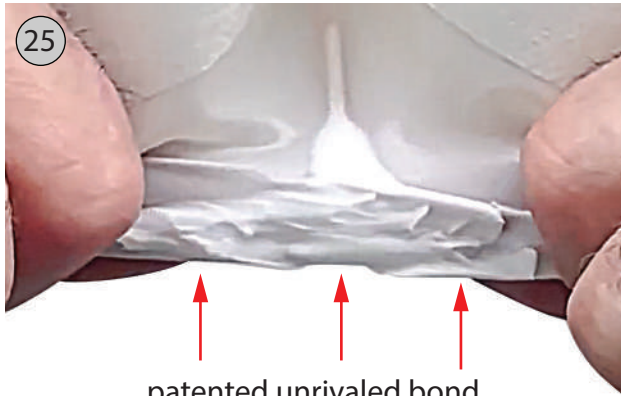

26. The finished installed product break down.

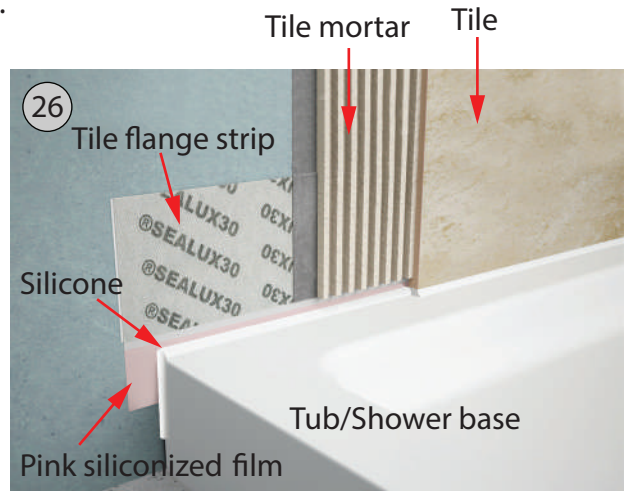

When 100% silicone is applied to the patented siliconized pink strip of Sealux waterproof membrane. It creates tenacious adhesion and flexibility (C).

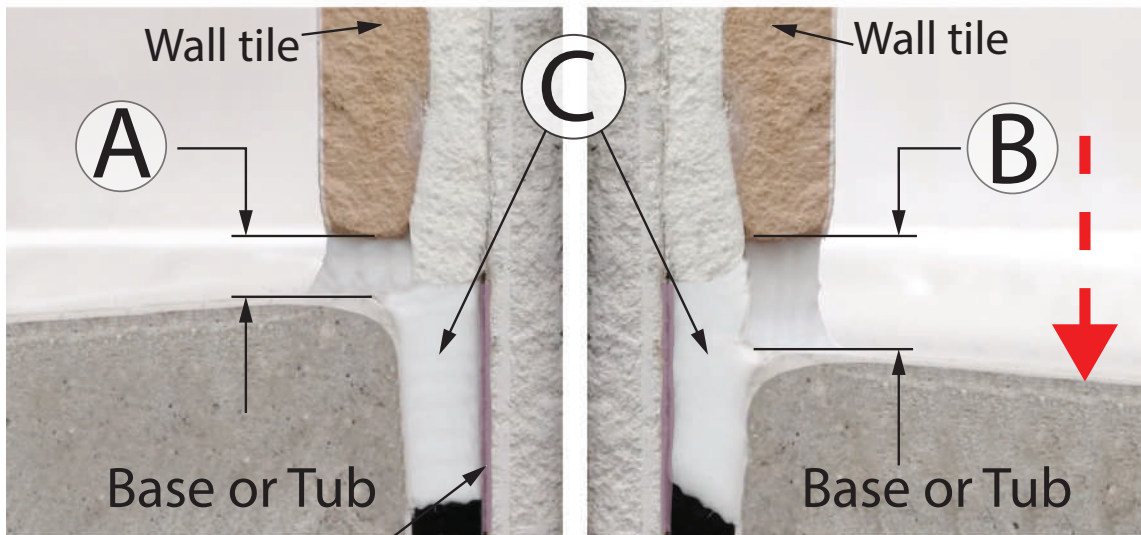

This guarantees waterproofing during the expansion or contraction that affects the gap (A & B) between the floor and the wall.